

# High Frequency Off Grid Solar Inverter

## PV1800 VHM Series (2KW-5.5KW)

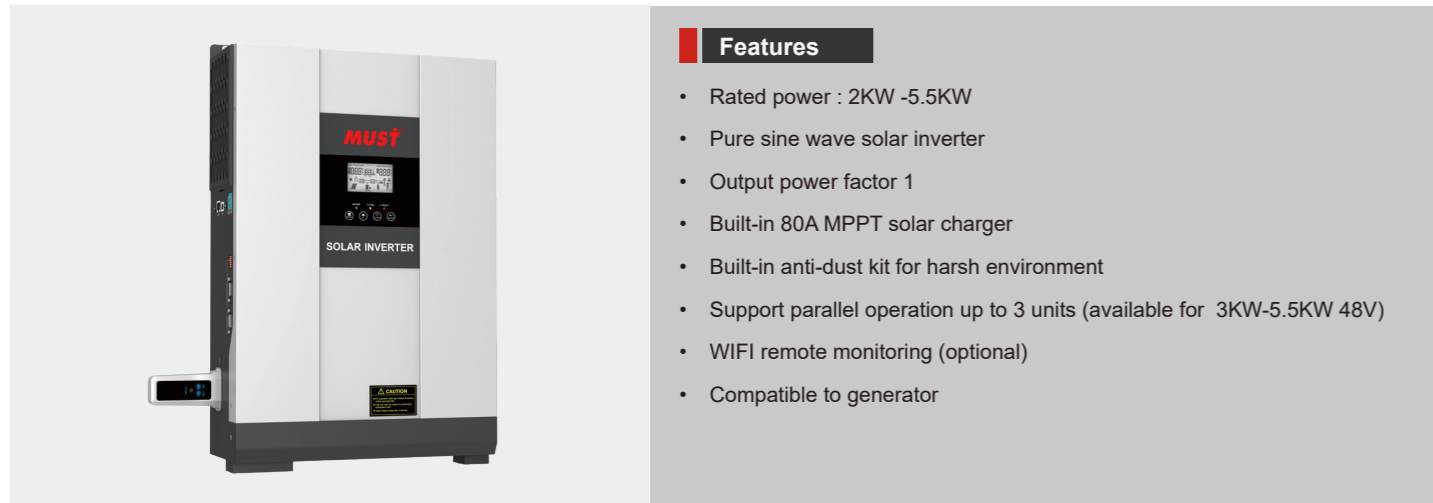

### Features

- Rated power : 2KW -5.5KW
- Pure sine wave solar inverter
- Output power factor 1
- Built-in 80A MPPT solar charger
- Built-in anti-dust kit for harsh environment
- Support parallel operation up to 3 units (available for 3KW-5.5KW 48V)
- WIFI remote monitoring (optional)
- Compatible to generator

### Introduction

PV1800 VHM is a multi-functional inverter/charger, combining functions of inverter, solar charger and battery charger to offer uninterruptible power support in portable size. Its comprehensive LCD display offers user-configurable and easy-accessible button operation such as battery charging current, AC/solar charger priority, and acceptable input voltage based on different applications.

### Back panel printing description

1. LCD Display
2. Status Indicator
3. Charging Indicator
4. Fault Indicator
5. Function Buttons
6. RS-485 Communication port
7. USB
8. Dry contact
9. Parallel switch
10. Parallel communication port (only for parallel model)
11. USB WiFi
12. Circuit breaker
13. AC input
14. AC output
15. Fan
16. Battery input
17. Power on/off switch
18. PV input

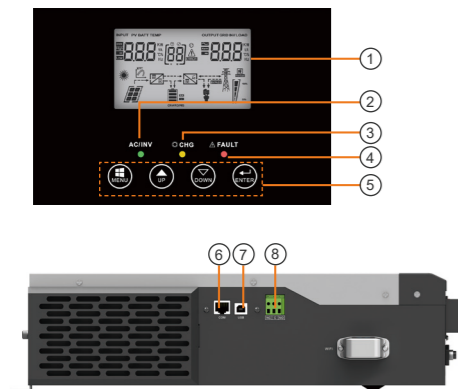

(2KW-3KW single model)

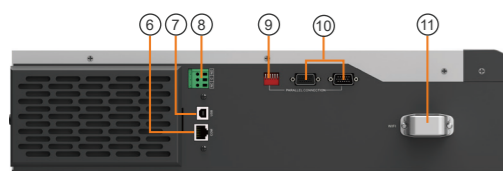

(3KW-5.5KW parallel model)

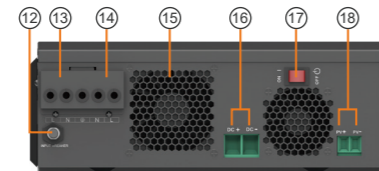

(2KW-3KW model)

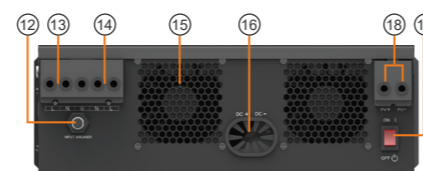

(3KW-5.5KW model)

### Solar system connection

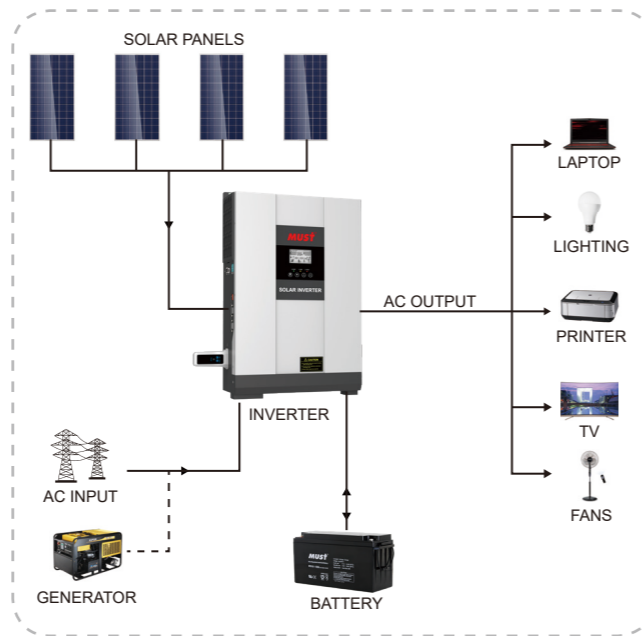

### Specification

MODEL		PV18-2024 VHM	PV18-3024 VHM	PV18-3048 VHM	PV18-4048 VHM	PV18-5048 VHM	PV18-5548 VHM
Nominal Battery System Voltage		24VDC		48VDC			
INVERTER OUTPUT	Rated Power	2000W	3000W	3000W	4000W	5000W	5500W
	Surge Power	4000W	6000W	6000W	8000W	10000W	11000W
	Waveform	Pure Sine Wave					
	AC Voltage Regulation (Batt.Mode)	(220VAC~240VAC)±5%					
	Inverter Efficiency(Peak)	93%					
	Transfer Time	10ms (UPS \ VDE4105) 20ms (APL)					
AC INPUT	Voltage	230VAC					
	Selectable Voltage Range	170~280VAC(UPS) \ 90~280VAC(APL) \ 184~253VAC(VDE4105)					
	Frequency Range	50Hz \ 60Hz(Auto sensing)					
BATTERY	Normal Voltage	24VDC		48VDC			
	Floating Charge Voltage	27.4VDC		54.8VDC			
	Overcharge Protection	30VDC		60VDC			
SOLAR CHARGER & AC CHARGER	Maximum PV Array Open Circuit Voltage	145VDC					
	PV Array MPPT Voltage Range	30~130VDC		60~130VDC			
	Standby Power Consumption	2W					
	PV Input Power	2000W		4000W			
	Maximum Solar Charge Current	80A					
	Maximum Efficiency	98%					
	Maximum AC Charge Current	20A/30A		60A			
Maximum Charge Current	80A		140A				
MECHANICAL SPECIFICATIONS	Machine Dimensions(W*H*D)(mm)	272*355*100		297.5*468*125			
	Package Dimensions(W*H*D)(mm)	540*395*241		638*395*241			
	Net Weight(kg)	10	11	13.3			
	Gross Weight(kg)	11.7	12	16.4			
OTHER	Humidity	5% to 95% Relatly Humidity (Non-condensing)					
	Operating Temperature	0°C~50°C					
	Storage Temperature	-15°C ~60°C					